

## GEARENCH VALVE WHEEL WRENCHES

### TITAN Valve Wheel Wrench

Page 2,3



TITAN VALVE WHEEL WRENCHES are used to provide leverage on hand operated valve wheels.

### TITAN Surgrip Valve Wheel Wrench

Page 4



TITAN SURGRIP VALVE WHEEL WRENCHES significantly reduce the chance of injury due to wrench slippage when opening and closing valves.

### TITAN "100 Series" Aluminum Valve Wheel Wrench

Page 5



TITAN "100 SERIES" VALVE WHEEL WRENCHES are made from aluminum-magnesium to reduce the chance of sparks when opening stubborn valves

### PETOL Valve Wheel Wrench

Page 6



The PETOL VALVE WHEEL WRENCH was designed for added safety when opening and closing stubborn valves.

### Titan Refinery Wrench

Page 7



The **TITAN REFINERY WRENCH** is a combination pipe wrench/valve wheel wrench designed for multiple uses in the refining, petrochemical, and gas processing industries.

## TITAN Valve Wheel Wrench



TITAN VALVE WHEEL WRENCHES are used to provide leverage on hand operated valve wheels. This series of wrenches permits a smooth snap "hammer-action" to make opening and closing stubborn valves easy. Each wrench will fit a variety of sizes and shapes of valve wheels. The special shaped opening in the wrench reduces the chance of slippage when working in overhead or crowded positions.

TITAN Valve Wheel Wrench				
ITEM	PATTERN	CAST OR FORGED	OVERALL LENGTH (approx.)	WEIGHT
<b>STEEL</b>				
VW0	Double-end	Forged	8"	0,40
VW0CPTC*	Double-end	Forged	8"	0,34
VW10	Double-end	Forged	10"	0,8
VW1	Single-end	Forged	15"	1,1
VW12	Double-end	Forged	18"	1,93
VW2	Single-end	Forged	22"	2,15
VW3	Single-end	Forged	27"	5,16
VW3L	Single-end	Cast	48"	6,9
VW4	Single-end	Forged	48"	7,4
VW5	Single-end	Cast	48"	7,14
VW6	Single-end	Cast	48"	7,14
<b>BRONZE</b>				
VW0BR	Double-end	Cast	8"	0,43
VW10BR	Double-end	Cast	10"	0,85
VW1BR	Single-end	Cast	15"	1,1
VW12BR	Single-end	Cast	15-1/2"	1,3
VW2BR	Single-end	Cast	22"	2,5
VW3BR	Single-end	Cast	30"	4,14
<b>ALUMINUM</b>				
VW0AL	Double-end	Cast	8"	0,14
VW10AL	Double-end	Cast	10"	4,76

## TITAN Valve Wheel Wrench

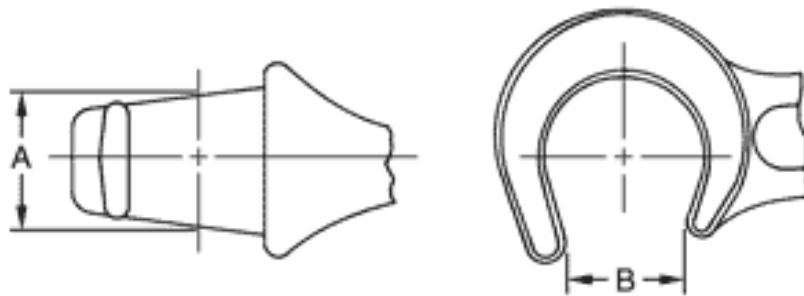

DIMENSIONS TITAN Valve Wheel Wrench				
ITEM	SMALL	LARGE	SMALL	LARGE
<b>SIZE</b>				
0	11/16"	7/8"	1/2"	21/32"
0CPTC	7/16"	7/16"	1/2"	21/32"
10	7/8"	1-3/16"	11/16"	1"
1	1-3/16"		1"	
12	1-1/2"	1-7/8"	1"	1-5/16"
12BR	1-1/2"		1-3/8"	
2	1-7/8"		1-5/16"	
3	2-1/2"		2"	
3L	2-3/4"		2"	
4	2-11/16"		2-1/4"	
5	2-3/4"		2-1/2"	
6	2-7/8"		2-3/4"	

## TITAN Surgrip Valve Wheel Wrench



TITAN SURGRIP VALVE WHEEL WRENCHES significantly reduce the chance of injury due to wrench slippage when opening and closing valves.

These durable, ductile iron wrenches are **safer** and **easier** to use because the head design provides a **better grip** and allows the operator to rest the wrench on top of the wheel when opening stubborn valves. This, along with **longer handle** lengths for **more leverage**, make the TITAN Surgrip the best valve wheel wrench on the market.

TITAN Surgrip Valve Wheel Wrench			
ITEM	PATTERN	OVERALL LENGTH (approx.)	WEIGHT
VW0SG	Double-end	8"	0,40
VW0LSG	Double-end	15"	0,62
VW10SG	Double-end	10"	0,68
VW12SG	Double-end	22"	2,1
VW1SG	Single-end	22"	1,8
VW2SG	Single-end	27"	2,55
VW3SG	Single-end	27"	5,44

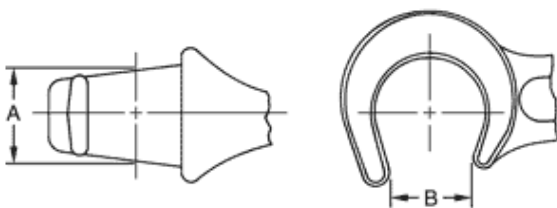

DIMENSIONS TITAN Surgrip Valve Wheel Wrench				
ITEM	SMALL	LARGE	SMALL	LARGE
<b>SIZE</b>				
VW0SG	3/8"	7/16"	1/2"	21/32"
VW0LSG	3/8"	7/16"	1/2"	21/32"
VW10SG	1/2"	9/16"	11/16"	1"
VW12SG	9/16"	5/8"	1"	1-5/16"
VW1SG		9/16"		1"
VW2SG		5/8"		1-5/16"
VW3SG		1-1/8"		2"

## TITAN 100 Series Valve Wheel Wrench



TITAN "100 SERIES" VALVE WHEEL WRENCHES are made from aluminium-magnesium to reduce the chance of sparks when opening stubborn valves.

An improved base pad design, a comfortable rounded gripping area, and the overall smooth finish of the wrench are features that add to the high standard of quality expected in all Gearench products.

TITAN "100 Series" Valve Wheel Wrench			
ITEM	OVERALL LENGTH (approx.)	OPENING	WEIGHT
VW101AL	13-5/8"	1-3/8"	0,96
VW102AL	17-5/8"	1-3/4"	1,59
VW103AL	25-1/2"	2-1/2"	3,52



## PETOL Valve Wheel Wrench



The PETOL VALVE WHEEL WRENCH was designed for added safety when opening and closing stubborn valves.

The wrench has a patented feature which fits over a spoke of the valve wheel to minimize the chance of the wrench slipping off the wheel when force is being applied.

In addition to this, the base pad has been improved by a deeper, more rounded design for a better fit on the valve wheel rim. This also reduces the chance of the wrench slipping.

Finally, the handle has been designed to provide the worker with a safer, more comfortable gripping area. PETOL Valve Wheel Wrenches are made from aluminium-magnesium and come in three sizes to fit a wide range of valve wheel diameters.

PETOL Valve Wheel Wrench			
ITEM	OVERALL LENGTH (approx.)	OPENING	WEIGHT
VWP1	13-5/8"	1-3/8"	1,02
VWP2	17-5/8"	1-3/4"	1,76
VWP3	25-1/2"	2-1/2"	3,46



Safer, more comfortable grip



Patented spoke strip



Improved base pad design

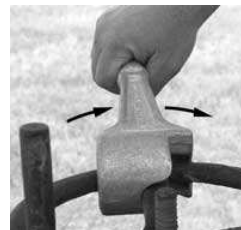
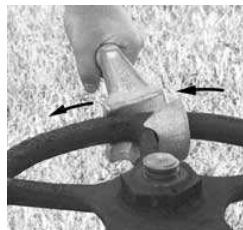

## TITAN Refinery Wrench



The **TITAN REFINERY WRENCH** is a combination pipe wrench/valve wheel wrench designed for multiple uses in the refining, petrochemical, and gas processing industries.

The valve wheel wrench has a special shaped opening which reduces the chance of slipping when working in overhead or crowded positions. Steel wrenches are available with "Surgrip" style valve wheel wrench opening to further reduce slipping.



The valve wheel wrench has a special shaped opening which reduces the chance of slipping when working in overhead or crowded positions.



Steel wrenches are available with "Surgrip" style valve wheel wrench opening to further reduce slipping.

TITAN Refinery Wrench				
ITEM	PIPE CAPACITY	WHEEL WRENCH OPENING	LENGTH (CLOSED)	WEIGHT
STEEL ("Surgrip" style valve wheel wrench opening)				
RW1SG	1/8" - 1"	3/4"	10"	0,74
RW2SG	1/8" - 1-1/2"	1/2"	10"	1,02
STEEL				
RW1	1/8" - 1"	3/4"	10"	0,68
RW2	1/8" - 1-1/2"	1/2"	10"	1,02
ALUMINUM (For light-duty applications only)				
RW1AL	1/8" - 1"	3/4"	10"	0,35
RW2AL	1/8" - 1-1/2"	1/2"	10"	0,46

## Titan El-Mac SURGRIP Valve Wheel Wrench



**TITAN™ "EL-MAC" SURGRIP™ VALVE WHEEL WRENCHES** are made from aluminium-magnesium to minimize sparking and have a "fist-like" head to reduce slipping even on stubborn valves. The wrenches are designed for use in the petroleum, petrochemical, pulp/paper, mining, marine and power generating industries.

<b>TITAN™ "EL-MAC" SURGRIP™ VALVE WHEEL WRENCHES</b>			
<b>ITEM</b>	<b>OVERALL LENGTH</b>	<b>OPENING</b>	<b>WEIGHT Kg</b>
EM9	9"	7/8"	0,4
EM11	11"	1"	0,57
EM15	15"	1 3/8"	1,02
EM19	19"	1 3/4"	1,56
EM28	28"	2"	3,18





## Titan Valve Wheel Latch Wrench



**The TITAN VALVE WHEEL LATCH WRENCH** actually grips the rim of the wheel to prevent the wrench from slipping when opening and closing valves. The patented latching mechanism pivots freely around a bushing and rivet allowing the wrench to be placed on and taken off the valve wheel with ease. The TITAN Valve Wheel Latch Wrench is made from alloy steel for strength and durability.

TITAN VALVE WHEEL LATCH WRENCH			
ITEM	OVERALL LENGTH	OPENING	WEIGHT Kg
VWL1	1 3/16"	11 1/4"	1,6

