

GEARENCH PETOL BULL TONGS



PETOL BUKUP TONGS are designed for use with a pipe machine for "bucking up" and "bucking off" tool joints. Larger sizes may be used for break breaking out drill collars, reamers or similar heavy jobs. The wide range of each size of PETOL Bukup Tong reduces to a minimum the tools needed for handling the many sizes of tool joints. The PETOL Special Chain combinations used with this tong come complete with heavy duty bolts, which make it possible to change quickly from one O.D. size to another. This tong grips in the upward motion and ratchets in the downward motion.

BUCKUP TONGS						
TYPE	O.D.*	GRIPPING WIDTH	HANDLE LENGTH	WEIGHT**	US MAXIMUM WORKING LOAD	Nm MAXIMUM WORKING LOAD
BA115H	2-1/8" - 8"	4.66"	48"	64 lbs.	16,000 ft.-lbs.	21680 Nm
BA116	4" - 10"	6.00"	48"	122 lbs.	42,000 ft.-lbs.	56910 Nm
BA116H	4-1/4" - 10-3/4"	6.06"	48"	147 lbs.	66,000 ft.-lbs.	89430 Nm
BA120	6" - 22"	10.88"	72"	546 lbs.	request torque table	request torque table
	*Chain assemblies must be ordered separately. State required OD on request.					
	**Weights do not include chain.					

WARNING! Do Not Exceed Maximum Working Load. Overloading may result in injury or death. Always use a load cell or other calibrated indicating device to monitor the line pull on the tong to avoid overload. Read Safe Practices & Procedures Manual prior to operation. Follow OSHA, NSC, etc. standards, safe practices, and procedures.



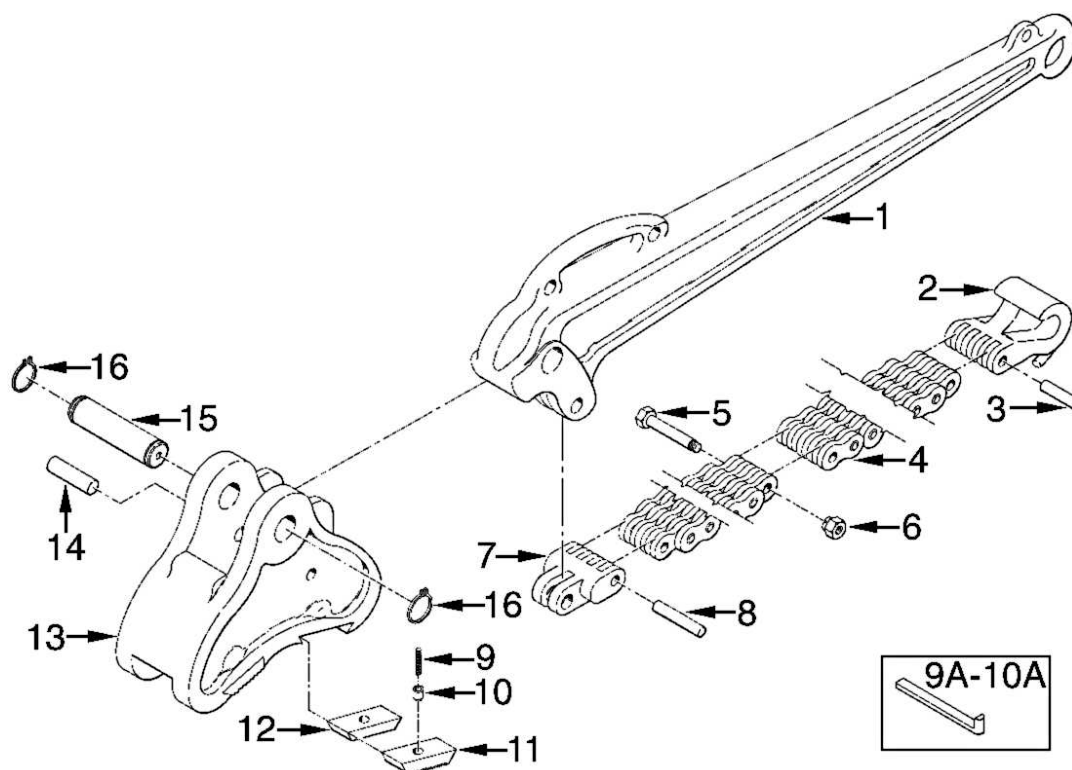

NOTE: PARTS MAY VARY SLIGHTLY AMONG SIZES.

KEY NO	ITEM DESCRIPTION	NO. REQ'D.
1	HANDLE	1
2	CHAIN HOOK	1
3	CHAIN HOOK PIN	1
4	SPECIAL CHAIN ONLY	1
5	SPLICE BOLT & NUT	as req.d'
7	MASTER LINK	1
8	MASTER LINK CHAIN PIN	1
9	INSERT KEY SPRING *	4
10	INSERT KEY*	4
11	INSERT	4
12	BLANK INSERT	2
13	JAW	1
14	MASTER LINK HANDLE PIN	1
15,16	JAW PIN W/ KLIPRIINGS	1
* OLDER MODEL TONGS REQUIRE INSERT PIN (9A-10A) IN PLACE OF INSERT KEY SPRING (9) AND INSERT KEY (10)		